

ROSSIGNOL AXIAL² WORLD CUP MFX DYNASTAR PX RACING MAXFLEX

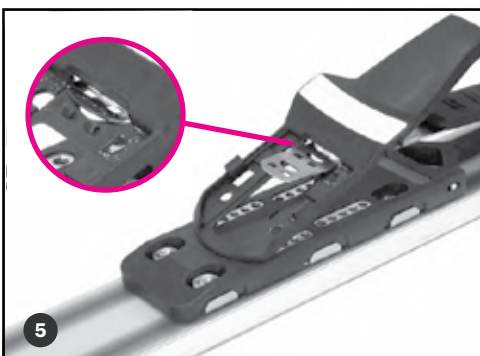

1. Insert cover at 30° angle to heel.
2. Push down toward metal bar to lock center plate in place.
3. Align heel with appropriate boot sole range.
4. Tighten screws and ensure heel piece is flush with ski or plate.
5. While lifting the front of the metal bar, insert AFD plate.
6. Slide AFD plate to the appropriate boot sole range.
7. AFD plate must match boot sole marking.
8. Position AFD by using the forward pressure screw at heel. Once the holes from the AFD align with the proper holes on the plate, connect the toe piece to AFD.
9. Tighten the screws with 5Nm of torque and ensure toe piece is flush with ski or plate.
10. To check the correct forward pressure, the mark on the screw should be lined up with the black plastic piece as shown below.
11. Go to page 31 for adjustment settings.

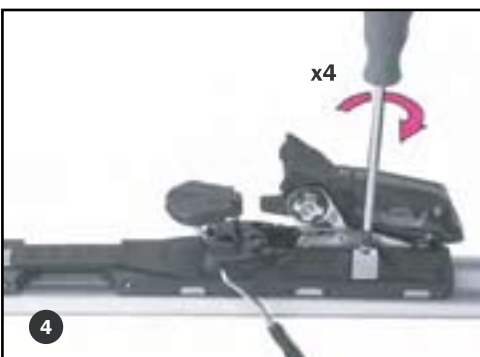
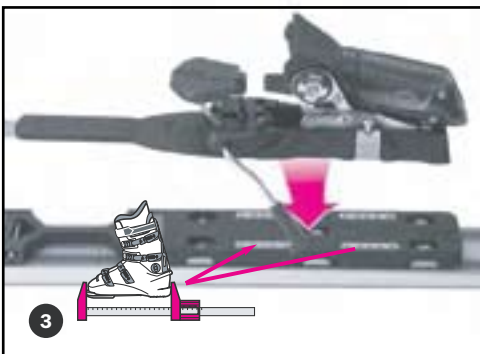
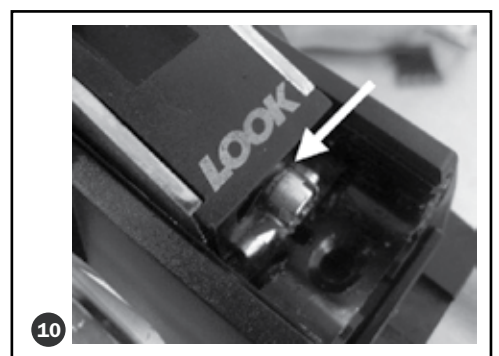
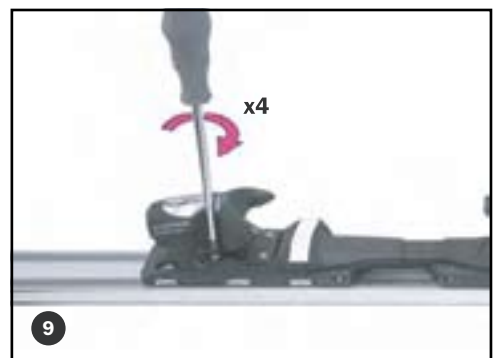
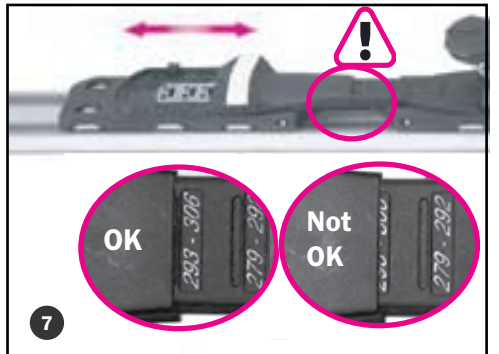
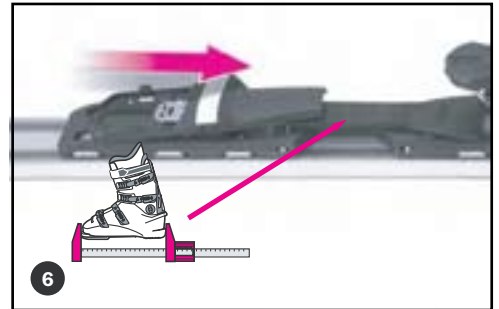

I-BOX WC / I-BOX / RACE FLEX WC PLATE BINDING MOUNTING

for Rossignol Axial² World Cup MFX and Dynastar PX Racing Maxflex



Quick Reference Chart for Binding Placement

<i>sole length range</i>	<i>toe piece mounting</i>	<i>heel piece mounting</i>
264-280mm		
281-294mm		
295-308mm		
309-325mm		
326-341mm		